

# PLAN URBANISTIC DE DETALIU

Construire locuinta unifamiliala  
com. Gilau, sat Somesul Rece, nr.cad.54391, jud. CJ

## BILANT TERITORIAL EXISTENT

Suprafata teren studiat = 6922 mp

| Funciune/Categ. folosinta | Supr. (mp)  | %          |
|---------------------------|-------------|------------|
| Faneata                   | 6922        | 100        |
| <b>TOTAL</b>              | <b>6922</b> | <b>100</b> |

## INDICI DE FOLOSIRE A TERENULUI

|                         |                 |
|-------------------------|-----------------|
| P.O.T. existent = 0.00% | P.O.T.max. =50% |
| C.U.T. existent = 0.00  | C.U.T.max. =1.5 |

### TABEL COORDONATE PARCELA

| Nr. Pct. | N [m]      | E [m]      |
|----------|------------|------------|
| 1        | 579670.884 | 372357.461 |
| 2        | 579655.665 | 372344.284 |
| 3        | 579633.358 | 372324.969 |
| 4        | 579625.826 | 372318.660 |
| 5        | 579617.582 | 372312.711 |
| 6        | 579614.315 | 372312.708 |
| 7        | 579617.365 | 372308.610 |
| 8        | 579621.221 | 372309.179 |
| 9        | 579624.081 | 372295.244 |
| 10       | 579685.321 | 372277.594 |
| 11       | 579684.737 | 372264.815 |
| 12       | 579705.731 | 372252.853 |
| 13       | 579719.388 | 372240.660 |
| 14       | 579739.481 | 372211.711 |
| 15       | 579762.317 | 372196.167 |
| 16       | 579773.980 | 372186.379 |
| 17       | 579790.401 | 372178.566 |
| 18       | 579809.275 | 372178.516 |
| 19       | 579810.503 | 372188.882 |
| 20       | 579800.506 | 372194.385 |
| 21       | 579784.213 | 372200.259 |
| 22       | 579769.373 | 372208.255 |
| 23       | 579758.241 | 372216.808 |
| 24       | 579745.614 | 372229.919 |
| 25       | 579737.535 | 372245.111 |
| 26       | 579730.456 | 372255.371 |
| 27       | 579724.267 | 372261.888 |
| 28       | 579715.417 | 372279.427 |
| 29       | 579710.533 | 372292.769 |
| 30       | 579700.609 | 372304.041 |
| 31       | 579694.118 | 372319.637 |

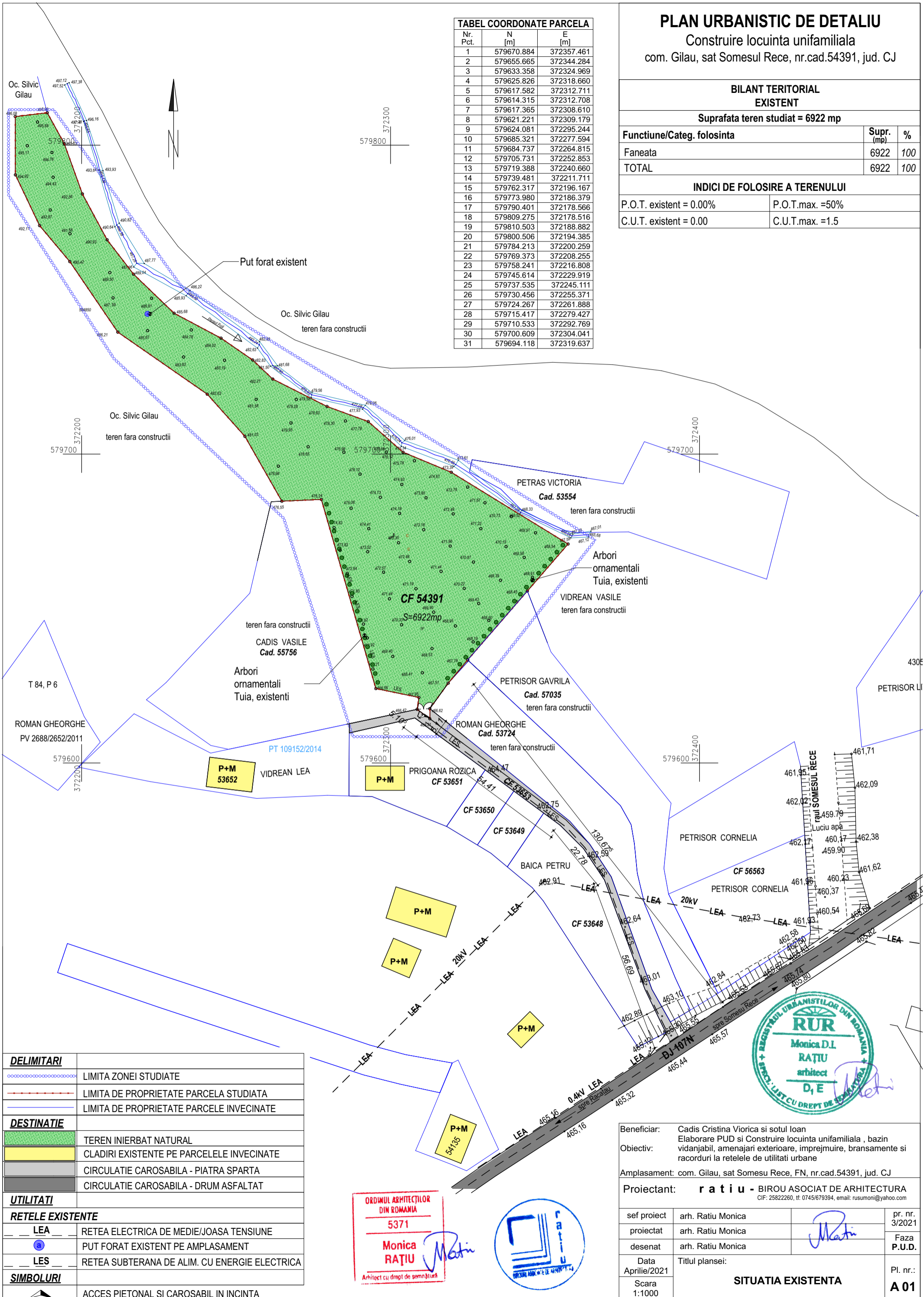

|                         |   |
|-------------------------|---|
| <b>DELIMITARI</b>       |   |
|                         | LIMITA ZONEI STUDIATE                         |
|                         | LIMITA DE PROPRIETATE PARCELA STUDIATA        |
|                         | LIMITA DE PROPRIETATE PARCELE INVECINATE      |
| <b>DESTINATIE</b>       |   |
|                         | TEREN INIERBAT NATURAL                        |
|                         | CLADIRI EXISTENTE PE PARCELELE INVECINATE     |
|                         | CIRCULATIE CAROSABILA - PIATRA SPARTA         |
|                         | CIRCULATIE CAROSABILA - DRUM ASFALTAT         |
| <b>UTILITATI</b>        |   |
| <b>RETELE EXISTENTE</b> |   |
|                         | RETEA ELECTRICA DE MEDIE/JOASA TENSIUONE      |
|                         | PUT FORAT EXISTENT PE AMPLASAMENT             |
|                         | RETEA SUBTERANA DE ALIM. CU ENERGIE ELECTRICA |
| <b>SIMBOLURI</b>        |   |
|                         | ACCES PIETONAL SI CAROSABIL IN INCINTA        |

ORDINUL ARHITECTURILOR  
DIN ROMANIA  
5371  
Monica RAȚIU  
Arhitect cu drept de semnătură



|                   |   |  |                |
|-------------------|---|--|----------------|
| Beneficiar:       | Cadis Cristina Viorica si sotul Ioan  |  |                |
| Obiectiv:         | Elaborare PUD si Construire locuinta unifamiliala , bazin vidanjabil, amenajari exterioare, imprejmuire, bransamente si racorduri la retelele de utilitati urbane |  |                |
| Amplasament:      | com. Gilau, sat Somesu Rece, FN, nr.cad.54391, jud. CJ  |  |                |
| Proiectant:       | <b>r a t i u</b> - BIROU ASOCIAT DE ARHITECTURA<br>CIF: 25822260, IF: 0745/679394, email: rusumoni@yahoo.com  |  |                |
| sef proiect       | arh. Ratiu Monica   |  | pr. nr. 3/2021 |
| proiectat         | arh. Ratiu Monica   |  | Faza P.U.D.    |
| desenat           | arh. Ratiu Monica   |  |                |
| Data Aprilie/2021 | Titlul plansei:   |  | Pl. nr.:       |
| Scara 1:1000      | <b>SITUATIA EXISTENTA</b>   |  | <b>A 01</b>    |